

**Needles: 4 3/4, 6 3/4**

**Size: 50**

**Gauge: 27 sts 40 rws per 10cm**

**Estimated Ydg: 526**

#### Back

With body needle, cast on 78 sts.

With body needle, work in pat st until piece meas 27"[row 108].

#### Armhole Shaping

Bind off 6 sts at beg of next 2 rws. Dec 1 st each side, every other row 6x.

Cont in pat st until piece meas 39 cm from start [row 156].

#### Shape Shoulders

Bind off 4 sts beg of next 2 rws.  
Bind off 4 sts beg of next 2 rws.  
Bind off 5 sts beg of next 2 rws.  
Bind off 28 back neck sts.

#### Front

*make two, [reversing shaping]*

With body needle, cast on 39 sts.

Work as for back, including all shaping,

and, at the same time

when piece meas 35.5 cm [row 142]

#### Begin Neck Shaping

At neck edge, bind off 9 sts  
Bind off 2 sts at each neck edge 1x  
Dec 1 st at neck edge, every other row 3x.

Cont in pat st until piece meas 39 cm from start [row 156].

#### Shape Shoulders

Work shoulder shaping (at shoulder edge) to correspond with back.

#### Work sleeves. (pg 2)

*Continued on page 2.*

**ATTENTION :**

R 44, passer en côtes 1/1, GM 4.75, pendant 40 rgs (R 94), puis repasser en Jersey GM 6.75 jusqu'au rg 108

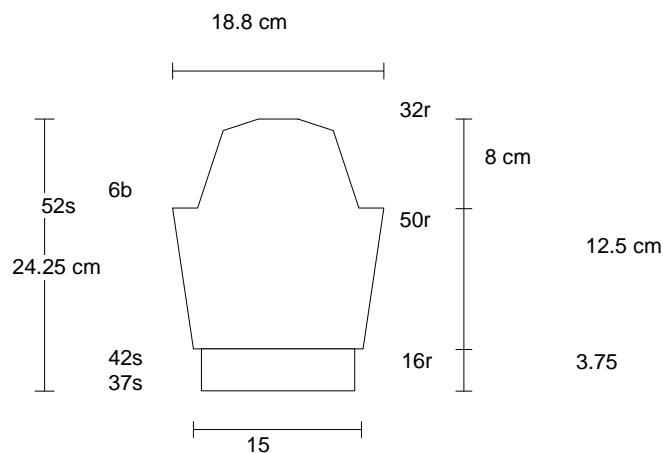

### Sleeves

With smaller needles, cast on 37 sts.  
Work same as body rib for 15 rws [3.75 cm]. On the next rib rw:

#### *Cuff-to-Sleeve-Inc Row*

Work 6 [inc 1 in next st, work 5, inc 1 in next st, work 6] 1 x, [inc 1 in next st, work 5] 3 x.

#### *Sleeve Shaping*

Using larger needle, work one RS row. Begin sleeve shaping: Inc 1 st on each side every 8th rw 2x, then every 10th rw 3x.

Cont in pat st until piece meas 16.25 cm [row 50].

#### *Cap Shaping*

Bind off 6 sts each side.  
Dec 1 st each side, every other row, 6x  
Dec 1 st each side every 5th rw 4x.  
Bind off 2 sts at the beg of next 4 rws.

Bind off rem 12 sts.

Join seams.

Weave in all ends.

Seam each shoulder. (13 sts)

Repeat instructions for right front.

#### Neck Finishing

Using smaller needle and RS facing, pick up 9 bound off sts from right front, pick up 2 sts from side bind off, pick up 15 side neck sts, pick up 28 back neck sts, pick up 15 left side neck sts, pick up 2 sts from side bind off, pick up 9 bound off sts. Working back and forth, estab pat. Inc or dec as necessary on the first row to balance pattern. Work for 2.5 cm. Bind off loosely in pat.

#### Bands

Finishing Bands: Right Front  
With smaller needles and RS facing, pick up 118 sts. Work 2.5cm in rib, end WS.  
Bind off neatly.

#### Left Front